

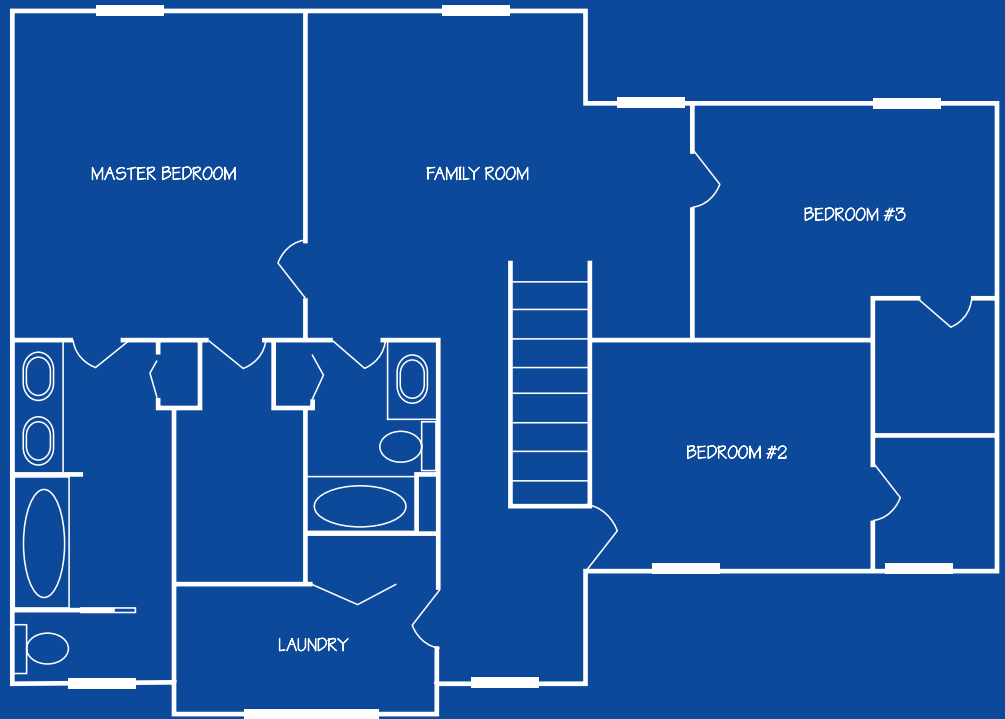

THE OAKMONT | CVE HOMES

2190 Sq. Ft.
3-5 Bedroom
2.5 Bath

Open Floor Plan
Spacious Master Suite
Gourmet Kitchen

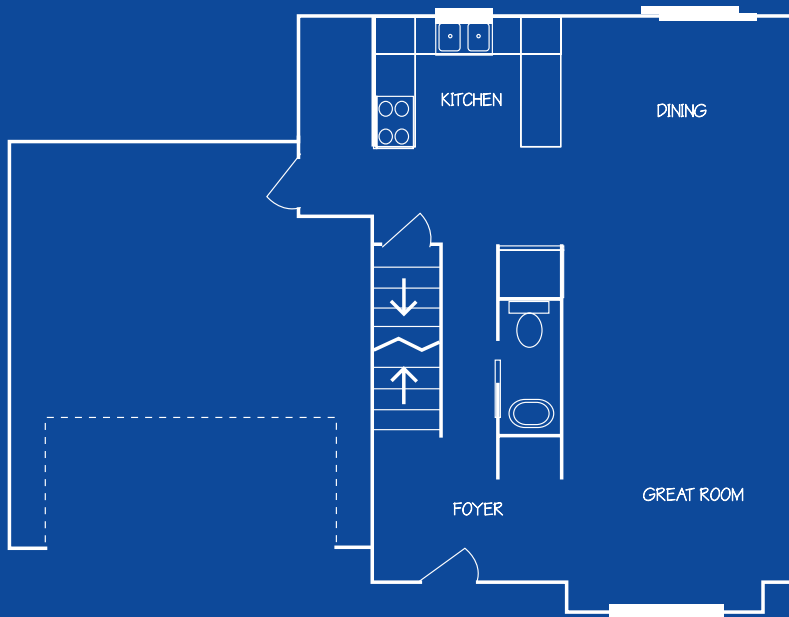

The Oakmont

This open floor plan, with a circular traffic pattern, makes the perfect entertainment hub.

First floor features include: large rooms, a kitchen with breakfast bar, a mudroom / pantry and great room feel.

Second floor features include: a spacious master suite, family room, laundry room and 2 more bedrooms with walk in closets and a computer nook.



CVE Homes
cvehomes.com